

exact

PipeCut P400

Cut and bevel plastic pipes in process

The Original
Pipe Cutting System
made by Exact Tools

Designed in Finland



Ø 100 mm - 400 mm (3,9" - 15,7")

d = 25 mm / 22 mm (0,98" / 0,86")



P400 cuts and bevels plastic pipes.

Unique method for plastic pipe installations. You just need to cut around a pipe and you get a good quality 15 degrees bevel at the same time. In addition you can use the PipeCut P400 saw also only for either only for cutting or only for bevelling plastic pipes.

www.exacttools.com

exact

PipeCut P400

Blades

There are two different types of cutting blades for Exact PipeCut P400 machines:

TCT P150 is a blade with tungsten carbide tips for cutting all plastic materials.

Cut Bevel blade is designed to cut and bevel plastic pipes in one process. The bevelling tips can be reversed when worn to obtain a new sharp cutting edge. There is also an upgrade kit available for the **Cut Bevel** blade. It contains one cutting blade and 8 pcs bevelling tips and the screws needed to fix this blade and tips to the blade body. This upgrade kit provides the operator with a Cut Bevel blade as good as new.

Pipes

Exact PipeCut P400 can be used to cut all types of plastic pipes. It can cut pipes with maximum 25 mm (0,98") wall. Also it can cut and bevel plastic pipes up to a maximum 22 mm (0,86") wall thickness.

Exact PipeCut P400 pipe cutting system package contents:

1. PipeCut shoulder bag
2. Exact PipeCut P400 pipe saw
3. Cutting supports 1 pc +2 pcs
4. Operating instructions booklet
5. Allen key 5 mm fitted to the machine
6. TCT blade P150 fitted on the machine and Cut Bevel blade
7. DVD-video disc containing instructions and demonstrations

Technical data

Model	Pipecut P400
Voltage	110 V, 120V and 230 V / 50-60 Hz
Power / Current	1010 W / 8.4 A
No-Load speed	4000 / min
Intermittent operation	2,5 min ON / 7,5 min OFF (S3 25%)
Blade diameter	148 / 150 mm (5.8" / 5.9")
Mounting bore	62 mm (2.44")
Weight	6,0 kg (13 lbs)
Range of use Ø	100 mm – 400 mm (3.9"-15.7")
Max. pipe wall	25 mm (0,98") cut, 22 mm (0,86") bevel cut

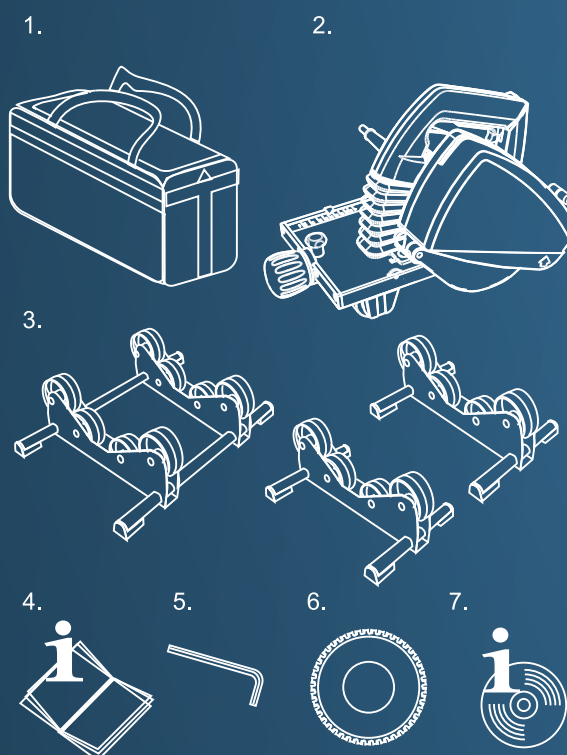

www.exacttools.com